

Stormy 455P

Open Stand and Agitator Pump 50HZ

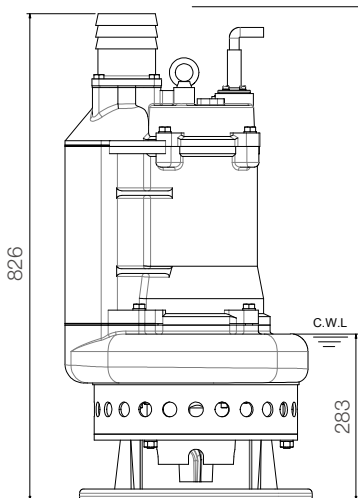
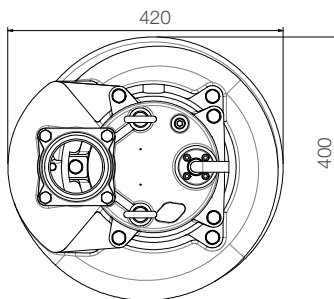

unit : mm

Weight : 124kg

Pump specifications

OUTPUT	HEAD	FLOW
5.5kW	Rated : 12m, 39ft	Rated : 18.3 L/s, 290gpm
7.5HP	Max : 17.5m, 57ft	Max : 37.5 L/s, 594gpm
SHAFT SPEED		1450rpm
OUTLET		100mm, 4in
SOLID PASSAGE		25mm, 1in

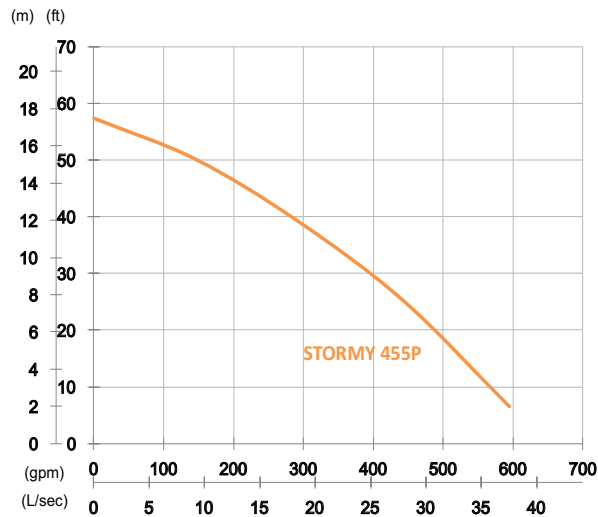

Features

Pump Type

Electric Submersible Pumps
 3-Phase

Motor

Type: Induction Motor
 Poles: 4 Pole
 Insulation: Class F
 Protector: Circle Thermal Protector
 Starter: D.O.L.

Lubricant

Food Grade (ISO VG32)

Impeller Type

Opened

Shaft Seal

Double Mechanical Seal
 Silicon Carbide VS Ceramic / Carbon

Bearings

C3 Shielded ball bearings

Cable

PVC (CSA Certified) / H07BQ-F
 10m or longer upon request

Materials

Pump Casing: Ductile Iron
 Impeller: Chromium Iron
 Motor Frame: Gray Iron
 Motor Shaft: Stainless Steel
 Wear Plate: Chromium Iron
 Agitator: Chromium Iron

Max. Liquid Temperature

40°C

Max. Submersion Depth

20m

pH Range

pH 5 - pH 8