

Titan 337

Heavy Duty Dewatering Pump 50HZ



Pump specifications

OUTPUT	HEAD	FLOW
3.7kW	Rated : 10m	Rated : 11.7L/s
5HP	Max : 15m	Max : 21.7L/s
SHAFT SPEED		1450rpm
OUTLET		80mm
SOLID PASSAGE		25mm

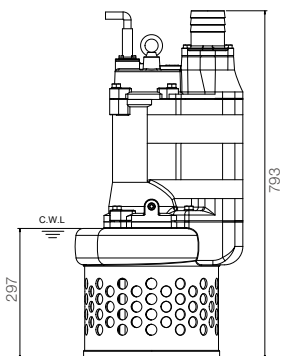
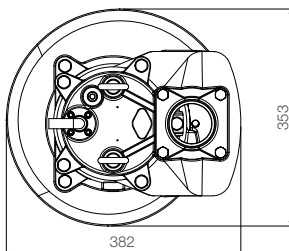
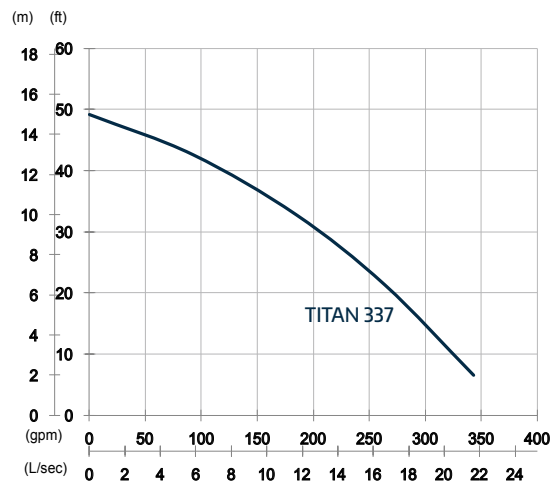

unit : mm
 Weight : 113kg

Features

Pump Type
 Electric Submersible Pumps
 3-Phase

Motor
 Type: Induction Motor
 Poles: 4 Pole
 Insulation: Class F
 Protector: Circle Thermal Protector
 Starter: D.O.L.

Lubricant
 Food Grade (ISO VG32)

Impeller Type
 Opened

Shaft Seal
 Double Mechanical Seal
 Silicon Carbide VS Ceramic / Carbon

Bearings
 C3 Shielded ball bearings

Cable
 PVC (CSA Certified) / H07BQ-F
 10m or longer upon request

Materials
 Pump Casing: Ductile Iron
 Impeller: Chromium Iron
 Motor Frame: Gray Iron
 Motor Shaft: Stainless Steel
 Strainer: Carbon Steel

Max. Liquid Temperature
 40°C

Max. Submersion Depth
 20m

pH Range
 pH 5 - pH 8